

mini JET

CUTTER



**MODEL
PC—1062**

INSTRUCTIONS & PARTS LIST

The **MINI JET CUTTER** provides a most powerful and amazingly fastest cutting performance, and a long trouble-free life is assured on account of specially engineered pneumatic motor.

This cutter has many distinguished features; namely, (1) Recessed shape for total visibility, (2) Powerful and duplicity noise silencer, (3) Troubleless through over-load, (4) One-touch sharpener, (5) Stationary carbide counter cutting blade, (6) Felt pad oiler and built-in lubricator, (7) Light weight only 0.9 kg (2 lbs.) (8) 6-different types of knife made from high-speed steel, (9) Grip style lever switch, and (10) Two-in-one Synchron system cutting base.

The following are the operating instructions for your Cutter (all numbers given below refers to parts list on the other side).

START TO OPERATE:

Connect **AIR INLET (M485)** to the compressor **AIR HOSE (M489)**. To operate Cutter, press **THROTTLE LEVER (M482)** and to stop operate, release Lever. The air motor uses 4.5 kg/cm² air pressure. 1.0 HP compressor required for 1 cutter (3 HP for 2 cutter).

When **COILING AIR HOSE (M488)** with one touch **AIR INLET (M486, M487)** in use, change **AIR INLET (M486)** in stead of **AIR INLET (M485)** and connect with **AIR INLET SOCKET (M487)** and **COILING AIR HOSE (M488)**

CUTTING:

Maximum cutting height is 8 mm (5/16") depending on type of materials. Lays should not be higher than its height.

To maintain perfect cutting performance, replace the **KNIFE (M700, M702 & M703)** when the knife is worn down to about 42 mm (1-5/8").

SHARPENING KNIFE:

Lightly press the sharpener **PUSH BUTTON (M528)** just enough for **SHARPENING STONE (M688Z)** to grind the rotating knife.

Don't press too hard because it will burr the knife.

You should keep knife always sharp for clean and accurate cutting.

LUBRICATION:

- (a) **OIL PAD (M680)** behind knife—Requires oil only when cutting plastics or the stiff materials which is apt to adhere to knife.
- (b) **GEARS (M450 & M452-A)**—In case Cutter uses daily, grease gears each 3 days with special red **GREASE (R672)** through bushing located in back of **GEAR HOUSING (M400AZ)**.

AIR MOTOR (M490B)— When the first operation, in order to remove dust during the transportation, give a plenty of clean oil—spindle oil #60—in the **AIR INLET (M485)**. In case Cutter uses daily, drops a few oil through the oil hole before and after the operation.

SYNCHRON SYSTEM CUTTING BASE:

SYNCHRON BASE (M460) use for general cutting purpose. Unscrew the **ROUND HEAD SCREW (M548)** and remove the **BASE PLATE (M426A)**, it converts easily to a **CUTTING FOOT (M424)** with **COUNTER BLADE (M729A)** for slitting or trimming of plastics or stiff material as well as knitted fabrics.

CHANGE VANES:

When the rotation of vane lowers after several months operation, overhaul and wear checking on the **VANES (M470)** are required. In case Vanes worn remarkably at the edge it must be replaced.

Separate the **CONNECTOR (M462B-A)** from the **MOTOR CASE (M476)** by turning counter clockwise. Tap the upper part of the motor case with a wooden hammer and draw the **ROTOR (M469)** out from the top. Then, the **CYLINDER (M472)**, **COUPLING (M416)**, **NUT (M465)**, **GUIDE PLATE (M466)**, **BALL BEARING (M467 & M474)**, **BRACKET (M468 & M473)**, **ROTOR (M469)**, **VANES (M470)**, **SPRING PIN (M471)** and **END PLATE (M475)** are all drawn out at the same time. For disassembling the motor section, it is enough only to pull them lightly.

THROTTLE VALVE & LEVER:

Usually, the air inlet valve section in the motor case requires no overhaul. In case of disassembly, after removing the **VALVE SCREW (M477)** by turning counter clockwise, the **PACKING (M478)**, **SPRING (M479)**, **BALL (M480)** and **VALVE PIN (M481)** can be easily draw out. **THROTTLE LEVER (M482)** can be separated by removing the **SPRING PIN (M483)**.

CHANGE SHARPENING STONE:

Remove the knife, then loose stepped screw (**M508**) to take out sharpening mechanism. Remove sharpening stone (**M688Z**) from stepped shaft (**M602**) by unscrewing flat head screw (**M510**) and put in new sharpening stone. Remove compression spring (**M620**) by unscrewing push button (**M528**) on stepped shaft. Replace sharpening mechanism into gear housing (**M400AZ**), insert stepped screw through gear housing and into stepped shaft. Then replace compression spring and push button. To clean sharpening stone, simply use cleaning fluid and a brush to keep it clean.

DRIVING MECHANISM

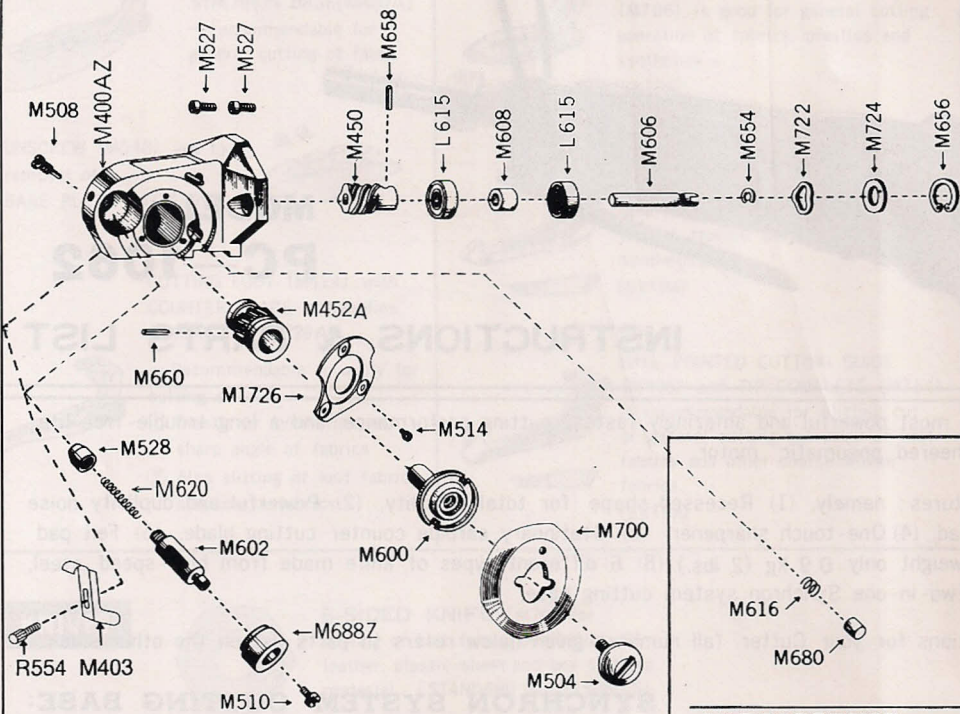

SHARPENING MECHANISM

LUBRICATING MECHANISM

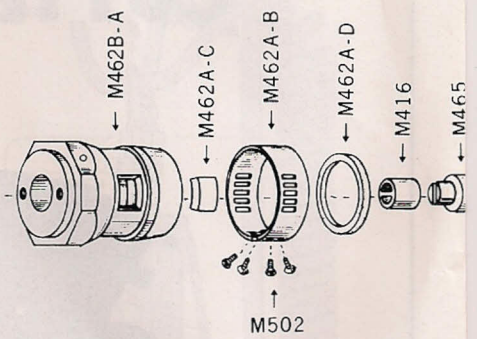

AIR MOTOR ASSY. M490B

KNIVES

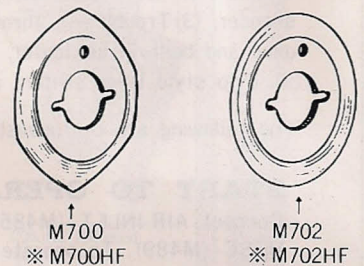

SYNCHRON SYSTEM BASE

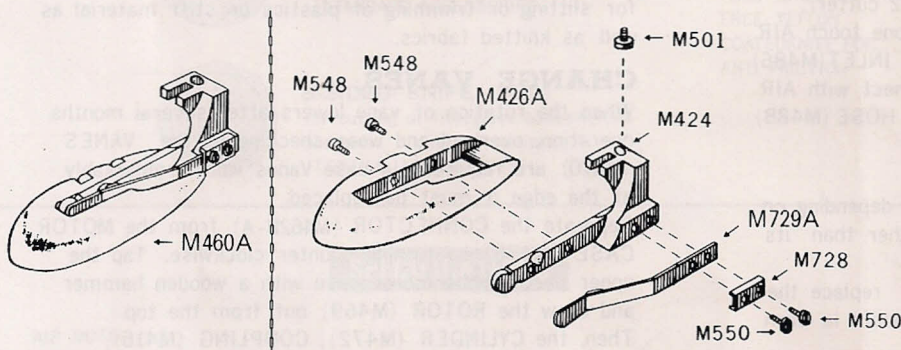

MICRON

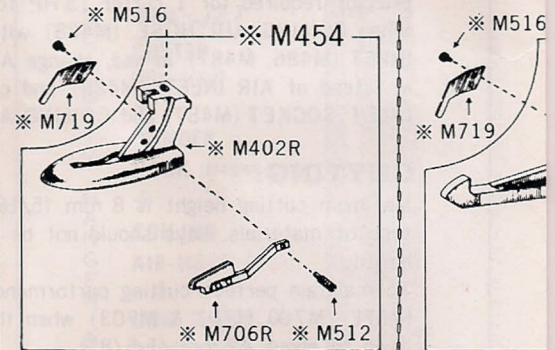

DRIVING MECHANISM

- M400AZ..... Gear Housing Complete
- M450..... Worm
- M452A..... Worm Wheel
- M527..... Allen Screw
- M504..... Knife Lock Screw
- M508..... Stepped Screw
- M514..... Fillister Head Screw
- M600..... Stepped Shaft
- M606..... Shaft
- M608..... Spacer
- L 615..... Ball Bearing
- M654..... E Ring
- M656..... Snap Ring
- M658..... Spring Pin
- M660..... Spring Pin
- M700..... 6-Sided Knife

- M722..... Undulated Washer
- M724..... Washer
- M1726..... Cover Plate Complete
- M440A..... Worm Wheel Assy.
- M403..... Finger Guard
- R554..... Knob Screw

SHARPENING MECHANISM

- M510..... Flat Head Screw
- M528..... Push Button
- M602..... Stepped Shaft
- M620..... Spring
- M688Z..... Sharpener Assy.
- M444..... Sharpener Assy.

LUBRICATING MECHANISM

- M616..... Spring

- M680..... Oil Pad

AIR MOTOR ASSY.

- M462B-A..... Connector
- M462A-B..... Silencer
- M462A-C..... Filter C
- M462A-D..... Filter D
- M416..... Coupling
- M465..... Nut
- M466..... Guide Plate
- M467..... Ball Bearing
- M468..... Front Bracket
- M469..... Rotor
- M470..... Vane
- M471..... Spring Pin
- M472..... Cylinder
- M473..... Rear Bracket
- M474..... Ball Bearing

- M475.....
- M476.....
- M477.....
- M478.....
- M479.....
- M480.....
- M481.....
- M482.....
- M483.....
- M484..... Air Inlet
- M485.....
- M494.....
- M490B..... AIR MOTOR ASSY.
- M502.....

EL PC-1062 PARTS LIST

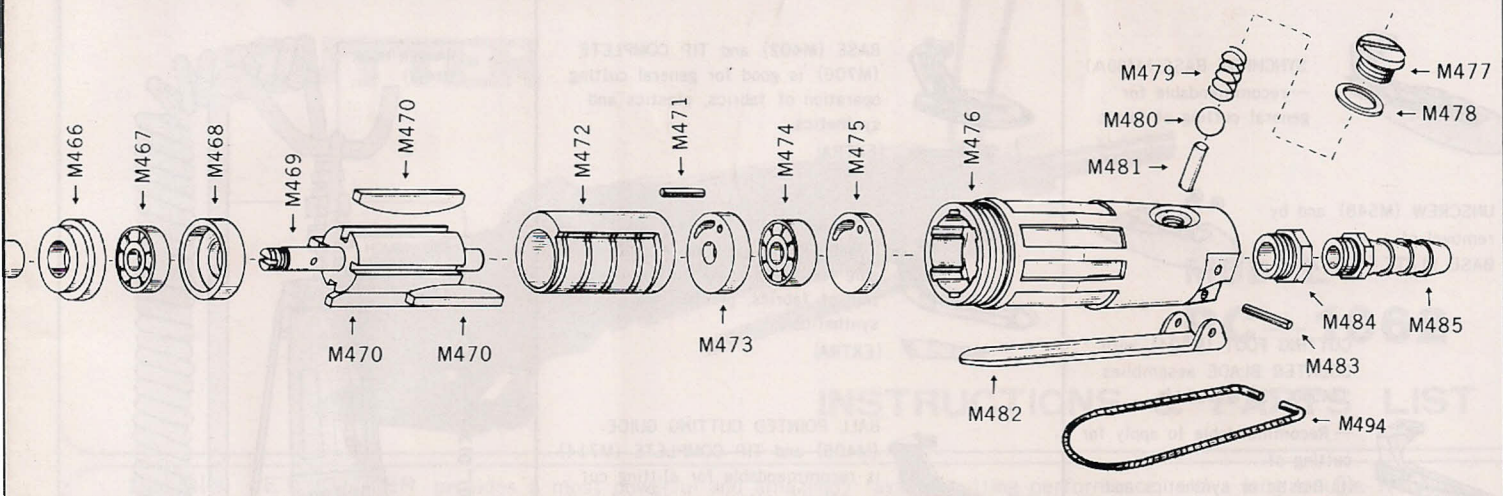

AIR HOSE

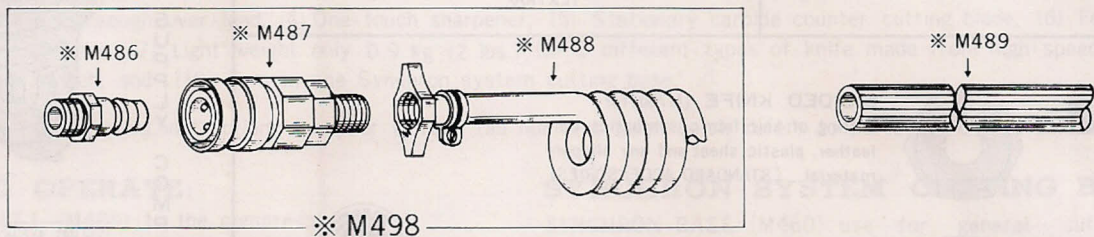

SYSTEM FEET

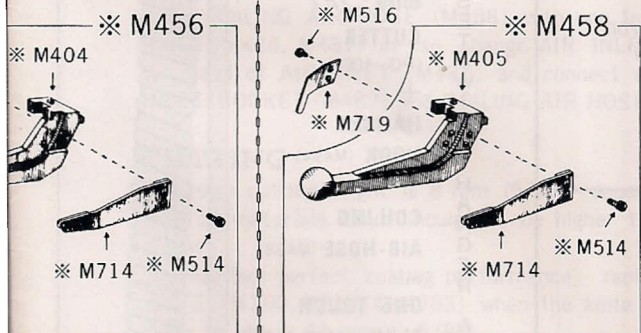

ACCESSORIES

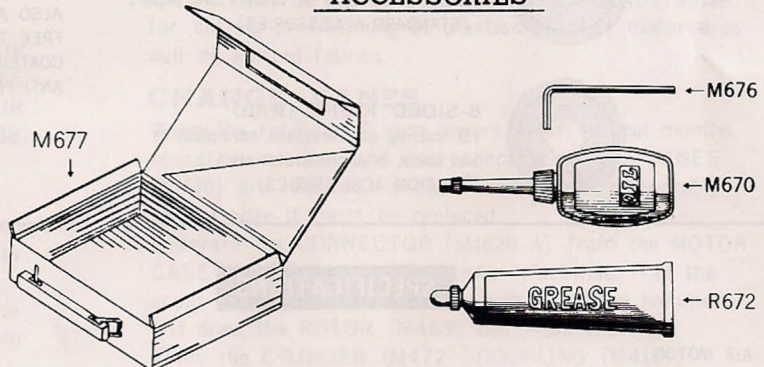

- End Plate
- Motor Case
- Valve Screw
- Packing
- Spring
- Ball
- Valve Pin
- Throttle Lever
- Spring Pin
- Joint (P.T.1/4)
- Air Inlet
- Hanger Hook

KNIVES

- M700.....6-Sided Knife
- ※ M700HF.....Heat Free Teflon 6-Sided Knife
- M702.....Round Knife
- ※ M702HF.....Heat Free Teflon Round Knife
- ※ M703.....8-Sided Knife
- ※ M703HF.....Heat Free Teflon 8-Sided Knife

AIR HOSE

- ※ M486.....Air Inlet (for M487)
- ※ M487.....Air Inlet Socket (for M488)
- ※ M488.....Coiling Air Hose (inside dia. 9.5 mm—3/8")
- ※ M489.....Polyuretane Air Hose
- ※ M498.....Coiling Air Hose Assy.

SYNCHRON SYSTEM BASE

- M424.....Cutting Foot
- M426A.....Base Plate
- M501.....Flat Head Screw
- M548.....Round Head Screw
- M550.....Flat Head Screw
- M728.....Plate
- M729A.....Counter Blade Complete
- M460A.....SYNCHRON BASE ASSY.

MICRON SYSTEM FEET

- ※ M402R.....Base
- ※ M404.....Cutting Guide
- ※ M405.....Ball Pointed Cutting Guide

- ※ M512.....Screw for Base
- ※ M514.....Fillister Head Screw
- ※ M516.....Truss Head Screw
- ※ M706R.....Cutting Tip (base)
- ※ M714.....Cutting Tip (Guide)
- ※ M719A.....Spring Plate
- ※ M454.....MICRON BASE ASSY.
- ※ M456.....CUTTING GUIDE ASSY.
- ※ M458.....BALL POINTED CUTTING GUIDE ASSY.

ACCESSORIES

- M670.....Oiler
- R672.....Tube of Grease
- M676.....Large Allen Key
- M677.....Vinyle Pouch

REMARKS: PARTS (MARKED BY ※) ARE OPTIONAL PARTS AND WILL BE SUPPLIED UPON REQUEST. WHEN ORDERING PLEASE INDICATE IF REQUIRED.

SYNCHRON SYSTEM BASE

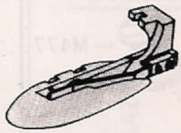

SYNCHRON BASE (M460A)
— recommendable for general cutting of fabric

UNSCREW (M548) and by removal of
BASE PLATE (M426A)

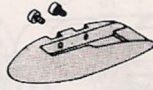

CUTTING FOOT (M424) with **COUNTER BLADE** assemblies (M550, 728 & 729A)

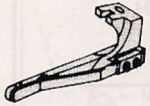

— Recommendable to apply for cutting of
① Plastic or synthetics and sharp angle of fabrics
② Also slitting of knit fabrics and coarse fabrics

MICRON SYSTEM FEET



BASE (M402) and **TIP COMPLETE (M706)** is good for general cutting operation of fabrics, plastics and synthetics.
(EXTRA)

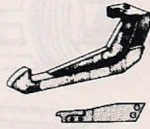

CUTTING GUIDE (M404) and **TIP COMPLETE (M714)** is recommendable for sharp angle cutting operation of fabrics, plastics and synthetics.
(EXTRA)

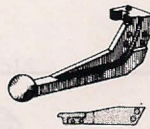

BALL POINTED CUTTING GUIDE (M405) and **TIP COMPLETE (M714)** is recommendable for slitting cut or general cutting operation of knit fabrics and other coarse woven fabrics.
(EXTRA)

KNIVES

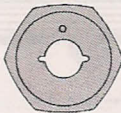

6-SIDED KNIFE (M700) for cutting of knit fabric, synthetics thin leather, plastic sheet and any slippery material. (STANDARD ACCESSORIES)

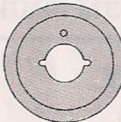

ROUND KNIFE (M702) for cutting of light to medium heavy weight of all type of fabrics and papers. (STANDARD ACCESSORIES)

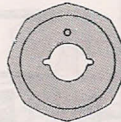

8-SIDED KNIFE (M703) for cutting of fibreglass, hard plastics and thick, slippery materials. (OPTION ACCESSORIES)



ALSO AVAILABLE **HEAT FREE TEFLON COATED KNIFE** FOR ANTI FRICTION

SPECIFICATIONS

AIR MOTOR:

Air pressure used : 4.5 kg/cm²
Max. horse power : 0.4 HP (300 W)
Max. Torque : 0.032 kg-m
Max. Speed with load : 9,000 r.p.m. (without load 20,000 r.p.m.)
Max. Air consumption with load : 3.8 m³/min. (without load 0.45 m³/min.)

AIR INLET:

Outside Diameter : 9.5 mm (3/8")
Inlet screw threading : 1/4 PT
Compressor (recommendable) : 1.0 HP compressor for 1 cutter

CUTTER:

Cutter : 3.0 HP compressor for 2 cutter
Diameter of knife : 50 mm (2")
Dimension : (H) 80 mm × (W) 50 mm × (L) 235 mm
Standard accessories : 2-knife (round and 6-sided), 1-allen screw wrench, 1-grease, and 1-oil.

WEIGHT : (NW) 0.9 kg (GW) 1.3 kg

HANGING STAND

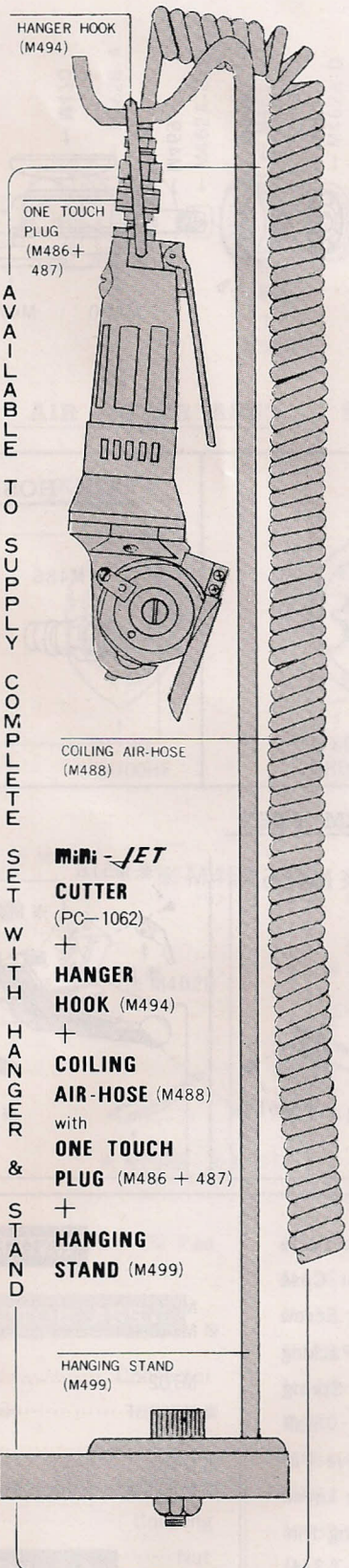

AVAILABLE TO SUPPLY COMPLETE SET WITH HANGER & STAND

Mini-JET CUTTER (PC-1062)
+ **HANGER HOOK (M494)**
+ **COILING AIR-HOSE (M488)**
with **ONE TOUCH PLUG (M486 + 487)**
+ **HANGING STAND (M499)**

AGENT :

Catalog #06.03.1000MDOC